

DETAIL F
SCALE 1 : 4

DETAIL G
SCALE 1 : 3

Assembling instruction:

1. Connect the front part (A) with the frame (B), fix them with the pin (C) trough the holes (G) and secure with the pin (D) into hole (F)
2. Fit the pin (H) as follow:
 - Trough hole I1 and J for left direction of the front part (A);
 - Trough hole I2 and J for straight position;
 - Trough hole I3 and J for right direction of the front part (A);
 and secure with the pin (K) trough hole (L)
3. Fit the leg (M) with the frame (B), fix with the pin (N) and secure with the pin (O) trough the hole (P)

UNLESS OTHERWISE SPECIFIED: DIMENSIONS ARE IN MILLIMETERS SURFACE FINISH TOLERANCES: IT12 LINEAR ANGULAR		FINISH: RAL 3000	DEBUR AND BREAK SHARP EDGES	DO NOT SCALE DRAWING	REVISION
DRAWN	NAME	SIGNATURE	DATE	TITLE	
CHECKED					
APPVED					
ENG					
QA			MATERIAL:	DWG NO.	A2
			WEIGHT: 173.84	SCALE: 1:20	SHEET 2 OF 4

Left direction

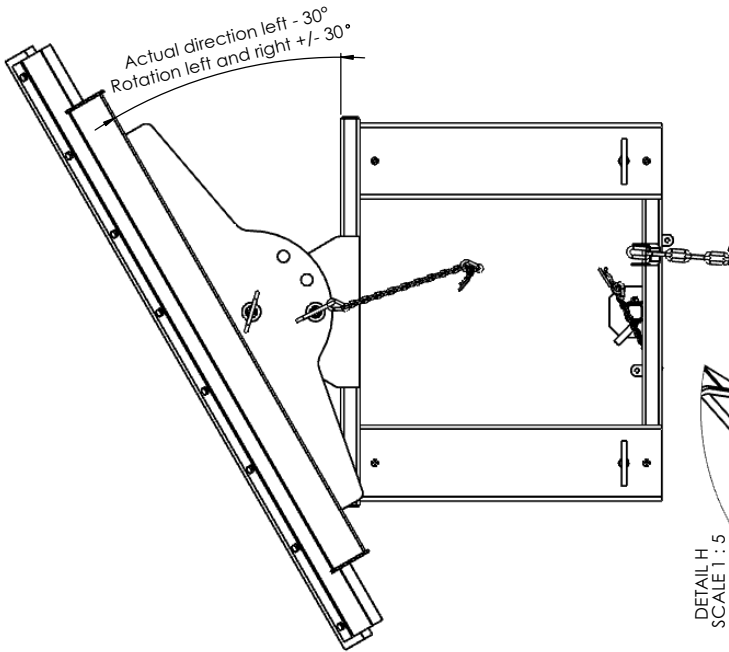

Straight position

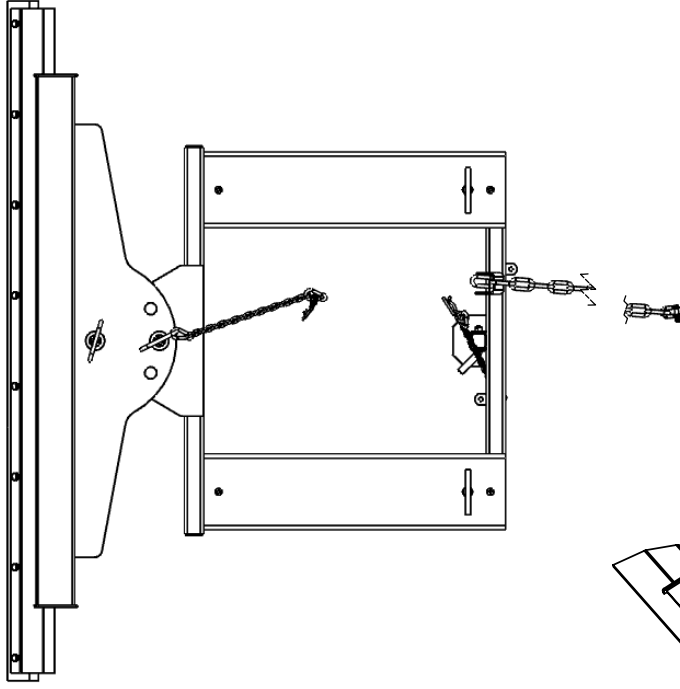

Right direction

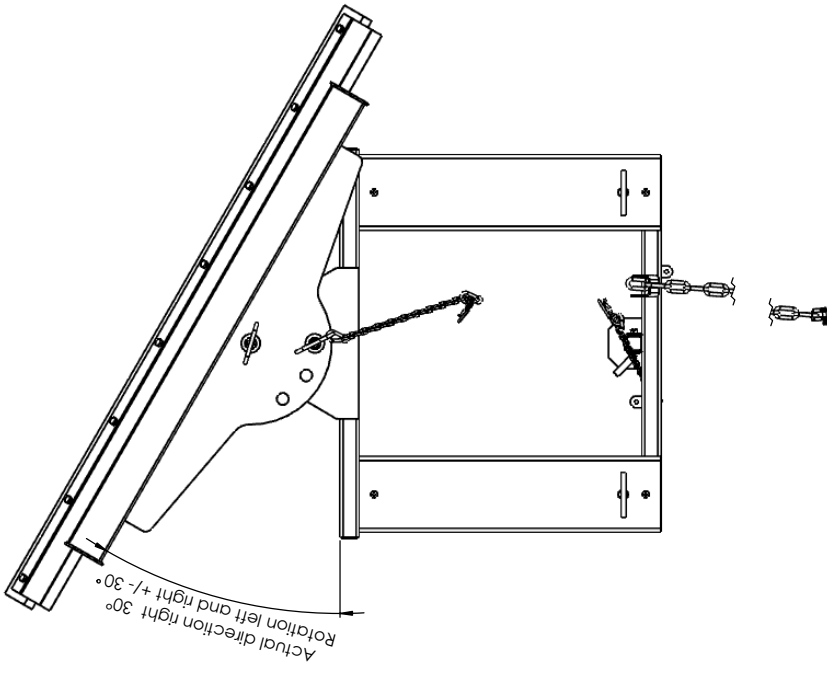

DETAIL H
SCALE 1 : 5

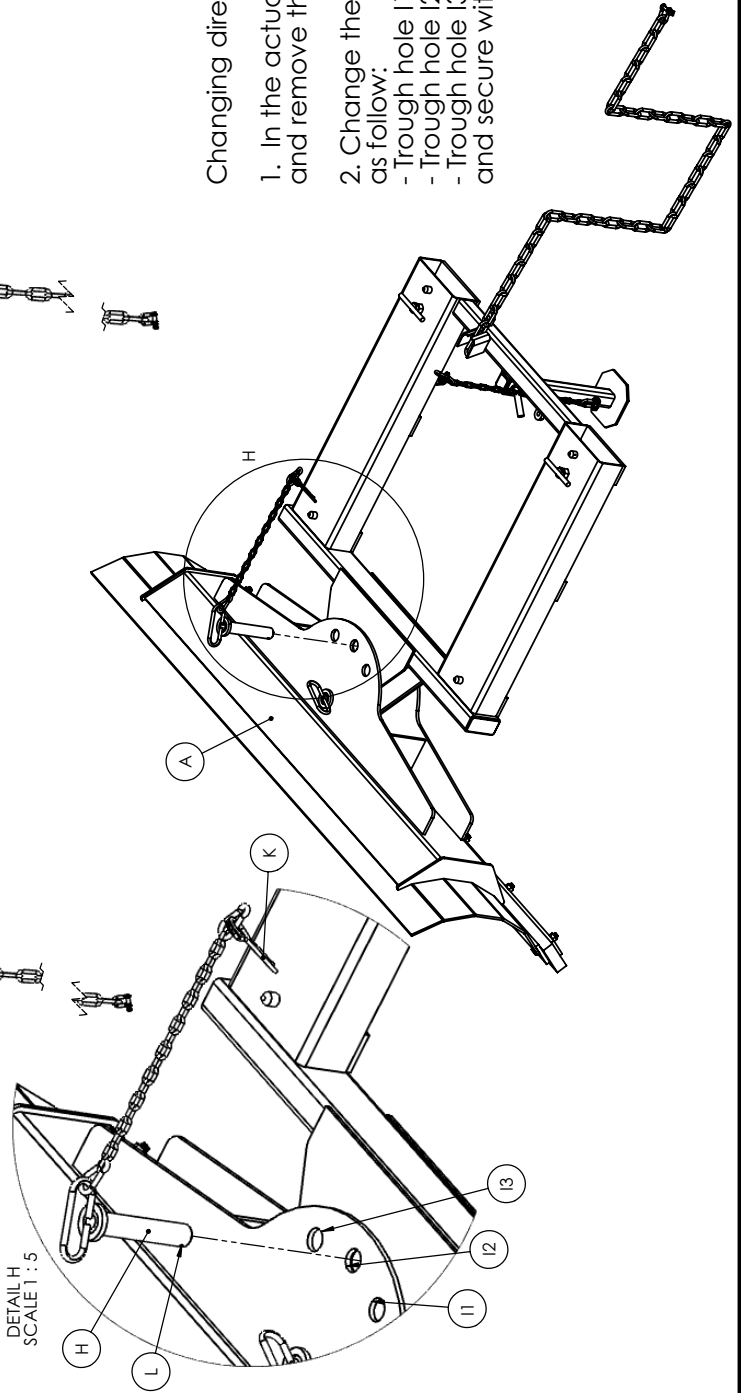

Changing direction:

1. In the actual position, remove the security pin (k) from the hole (L), and remove the pin(H)
2. Change the direction of the front part (A) and Fit the pin (H) as follow:
 - Trough hole 11 for left direction of the front part (A);
 - Trough hole 12 for straight position;
 - Trough hole 13 for right direction of the front part (A);
 and secure with the pin (K) trough hole (L)

DIMENSIONS ARE IN MILLIMETERS DIMENSIONS ARE IN MILLIMETERS DIMENSIONS ARE IN MILLIMETERS		FINISH		INDUSTRIAL DRAWING		REGION	
RAL 3000		RAL 3000		RAL 3000		RAL 3000	
NAME	SCALE	DATE	DATE	DATE	DATE	DATE	DATE
NO.	NO.	NO.	NO.	NO.	NO.	NO.	NO.
MATERIAL	MATERIAL	MATERIAL	MATERIAL	MATERIAL	MATERIAL	MATERIAL	MATERIAL
BSPN-0412		BSPN-0412		BSPN-0412		BSPN-0412	
A2		A2		A2		A2	